



76 Bailey Street Amphitheatre VIC

1 1

Oh Lordy be! I have found what your next property could be. Built around 1906, this is Saint Patrick's Catholic Church in Amphitheatre, just a short distance from Avoca in the beautiful Pyrenees Ranges of Victoria. The land is over 1 acre with a 4050 m² corner block, township zone, with power and mains water available. It is situated across from the local park area on the main road, with road access from Evans Street.

This property features a brick construction with an iron roof and spectacular timber ceilings with beautiful beams. It includes separate areas at each end of the building, as well as bathroom facilities accessible from the exterior.

The large land offers ample space and spectacular views of the surrounding ranges. It is located about 14 km from

Price : \$ 231,000
Land Size : 4050 sqm
View : <https://www.maryboroughballaratrealstate.com.au/sale/vic/ballarat-western-district/amphitheatre/residential/house/8077396>



Kate Ashton
03 5460 5100
0418 521 346

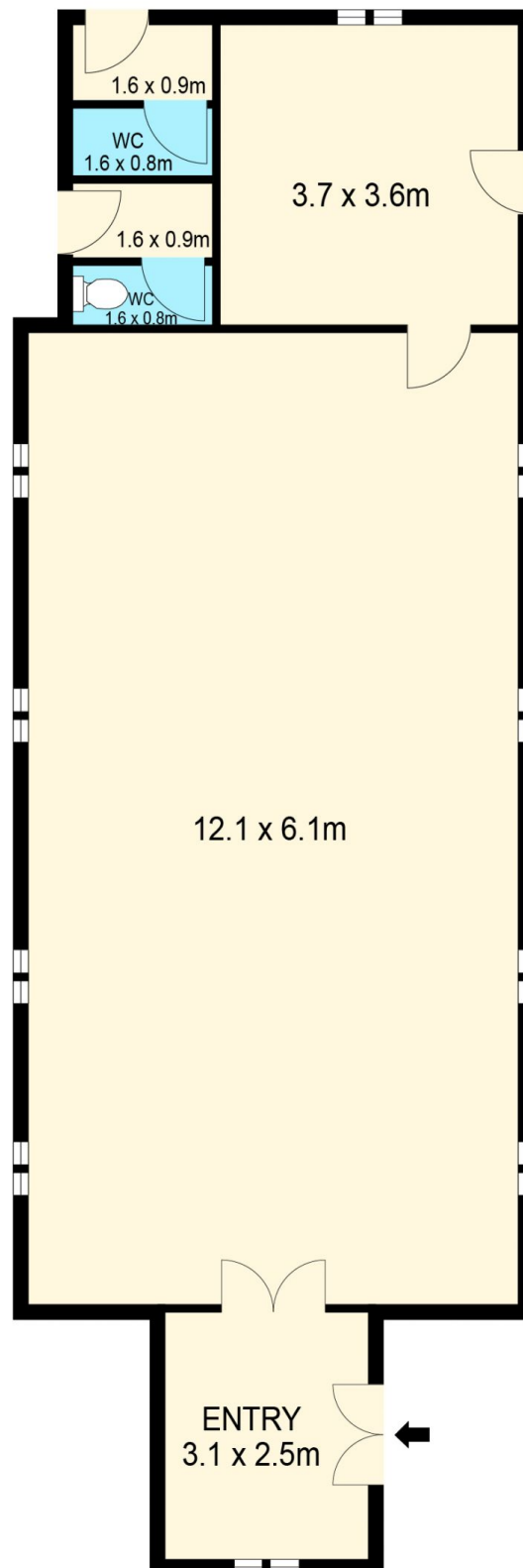

DISCLAIMER

PLANS SHOWN ARE FOR MARKETING PURPOSES ONLY, ALL DIMENSIONS ARE APPROXIMATE AND NOT TO SCALE. THEY ARE SUBJECT TO ERRORS AND INACCURACIES AND NO LIABILITY WILL BE ACCEPTED. INTERESTED PARTIES SHOULD MAKE THEIR OWN INQUIRES.

Maryborough

